

Proposed Section Drumalee Road

- Line of sight
- Outline of existing buildings to be demolished
- Outline of existing ground level

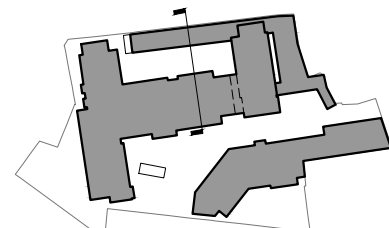

Revision Description	Date	Rev. No.	Issued by

LRD Planning Submission 11-03-2024 C01 AW  
 Any reference to fire safety design or performance is presented for coordination purposes only. Refer only to the granted Fire Safety Certificate, and fire consultant's information for fire safety design, specification and performance.  
 Figured dimensions only to be used. This drawing is copyright of O'Mahony Pike Architects Ltd. All information is shared as per approved use in accordance with BS1192(2007) + A2(2016), Table 5; Standard Codes for Suitability of Models and Documents. If 'Information Approval Check' is empty, this information has been shared at S0 - WIP.

**mahony pike**

architecture | urban design  
 email: info@mahonypike.com  
 tel: +353 1 202 7400  
 fax: +353 1 283 0822  
 www.mahonypike.com

**Dublin**  
 The Chapel  
 Mount St. Anne's  
 Milltown, Dublin 6  
 D06 XN52 Ireland

**Cork**  
 One South Mall  
 Cork City  
 Co. Cork  
 T12 CCN3 Ireland

**Project Code:** -  
**Project Lead:** CK  
**Drawn By:** MW  
**Job No.:** 23017  
**Purpose:** Planning

**Scale @ A3:** 1:200  
**Date Printed:** 11-03-2024  
**Current Rev.:** C01  
**Status:** A3

**Project:** Student Housing At Prussia Street  
**Location:** Prussia Street, Dublin  
**Client:** Lyonshall Ltd.

**Drawing Title:** Proposed Section Drumalee Road  
**Drawing No.:** 23017-OMP-01-ZZ-DR-A-3100